



TP Link Router Programming

4-Port Router
Model No. TLR402M

8-Port Router
TL-R860

AN-2013080801



Purpose

Provide LAN DHCP connectivity for BAYweb devices by assigning a static address to the WAN port on the router.

1 – Turn off all of your network devices, including your computer, Modem and the Router.

2 – Connect your computer to a LAN (yellow) Port labeled 1~4 on the Router using an Ethernet cable.

3 – Plug the Power Adapter into the Power jack on the back of the Router and the other end to a standard wall socket.

4 – Open a web browser and type <http://192.168.1.1> in the address bar, press **Enter**

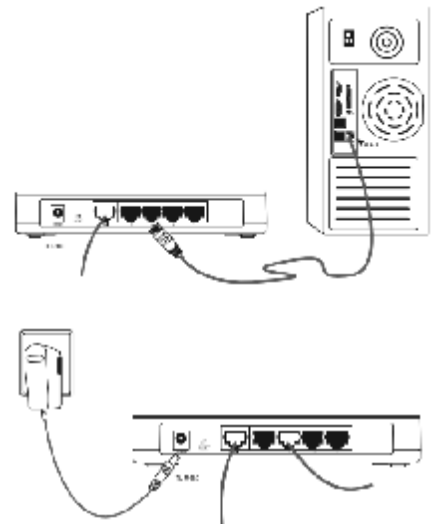

5 – A dialog box will prompt you for the **User name** and **Password**. Enter the default values and click **OK**.

User name: admin

Password : admin

6 – Select **Quick Setup** from the left side menu and select **Static IP**

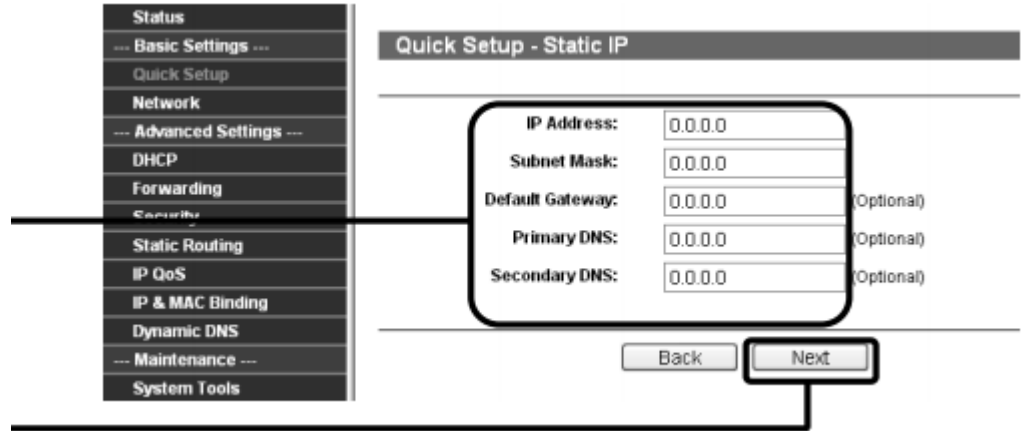

7 – Enter the IP address, Subnet Mask, Gateway, and DNS information as required by your network or ISP.

8 – Click **Next**

9 – Click **Finish**

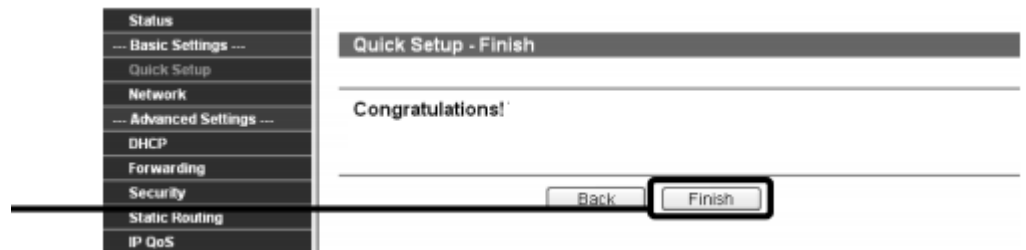

10 – Connect the WAN Port on your Router to your existing network/Internet connection.

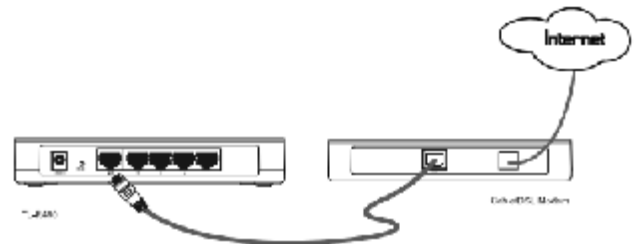

11 – Connect a LAN Port on your Router to your BAYweb Thermostat.

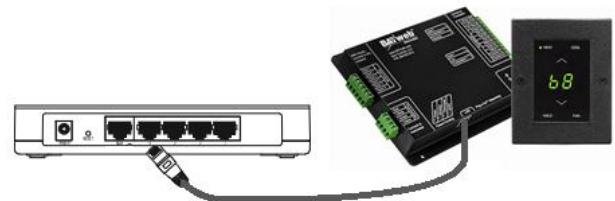

12 – The **Uplink** light on the BAYweb Control should illuminate in less than a minute. If you do not see the **Uplink** light up within a couple of minutes, refer to troubleshooting section of a BAYweb Thermostat Manual.

6"

4"

MOUNT ON TWO #6 PAN HEAD
SCREWS SEPARATED BY 4 5/8"

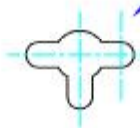
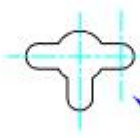

BAY CONTROLS, LLC.

6528 WEATHERFIELD CT.
MAUMEE, OHIO 43537

(419) 891-4390
FAX (419) 891-4399

BAYweb - 4 PORT ROUTER

MOUNTING TEMPLATE

6 7/8"

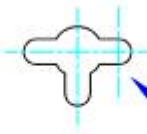

MOUNT ON TWO #6 PAN HEAD
SCREWS SEPARATED BY 5 3/8"

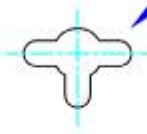

4 3/4"



BAY CONTROLS, LLC.

6528 WEATHERFIELD CT.
MAUMEE, OHIO 43537

(419) 891-4390
FAX (419) 891-4399

BAYweb - 8 PORT ROUTER

MOUNTING TEMPLATE